



A.O. SMITH
WATER PRODUCTS
COMPANY
PSD - Alsip, Illinois

WATER HEATER BULLETIN

Date: December 20, 1999
Subject: Gas Water Heater Conversion Policy
To: All Accounts

No. 137 Rev. 2

* This supersedes all previous letters and field bulletins concerning residential and commercial water heater conversion.

GAS WATER HEATER CONVERSION POLICY

All A.O. Smith Water Products Company's residential and commercial gas water heaters are designed certified by CSA or UL, under ANSI Standards for operation on one type of gas only, as indicated on the water heater's model number and rating plate.

A.O. Smith realizes that there may be certain situations where a field conversion may be necessary and in order to facilitate such a conversion, A. O. Smith complies with CSA or UL regulations ensuring that a field conversion be appropriately and safely completed.

An improper field conversion from one type of gas to another could cause potentially dangerous conditions that may cause an explosion or fire resulting in property damage, bodily injury or both.

A.O. SMITH WILL ONLY ALLOW THE CONVERSION OF GAS WATER HEATERS FROM LP GAS (PROPANE) TO NATURAL GAS. THE CONVERSION OF A GAS WATER HEATER FROM NATURAL GAS TO LP GAS (PROPANE) IS NOT ALLOWED UNDER ANY CIRCUMSTANCES.

A.O. Smith will provide kits as demand warrants through our Parts Department, phone no. 1-800-433-2545. Prices, dimensions and specifications are subject to change without notice.

Each conversion kit is to be installed by an A.O. Smith service agent or a gas utility serviceman in accordance with A.O. Smith's written instructions and all codes and requirements of the authority having jurisdiction. Failure to follow instructions could result in serious injury or property damage. The utility performing this work assumes responsibility for this conversion.

Changing the Input on Gas Water Heaters

The only changes to the input of a gas water heater allowed are:

- Adjustments to match that shown on the rating plate of the heater. The installation instructions supplied with the heater indicate if adjustments to input are a required procedure.
- Changes made as required to adjust the heater for proper operation at high altitude as determined by a qualified service technician. Service manuals include the proper procedure for adjusting heaters at high altitudes.

Conversion of Gas Water Heaters

The conversion of LP gas (Propane) to Natural gas is **ONLY** allowed providing:

- The conversion is done as part of a gas utility's program where propane appliances were installed anticipating the completion of natural gas service to the area. The conversion must be done under the direct supervision of the utility and by their service representatives.

Claims of damage or injury arising from the unauthorized conversion of any A.O. Smith water heater not design certified for conversion will be the complete and total responsibility of the person or entity making the conversion.

If you have any questions regarding the above policy, please contact the A.O. Smith Parts Department at 1-800-433-2545 or our Technical Information Center at 1-800-527-1953.

A.O. SMITH WATER PRODUCTS CO., INC.
5621 W. 115TH STREET • ALSIP, ILLINOIS 60803
PHONE: 1-800-433-2545
FAX: 1-800-433-2515 • www.hotwater.com

A.O. SMITH

WATER PRODUCTS COMPANY

PSD-1-283

GAS

RESIDENTIAL WATER HEATER PARTS LIST
MODELS FPSE - 40 & 50,
SERIES 236/237/240/241

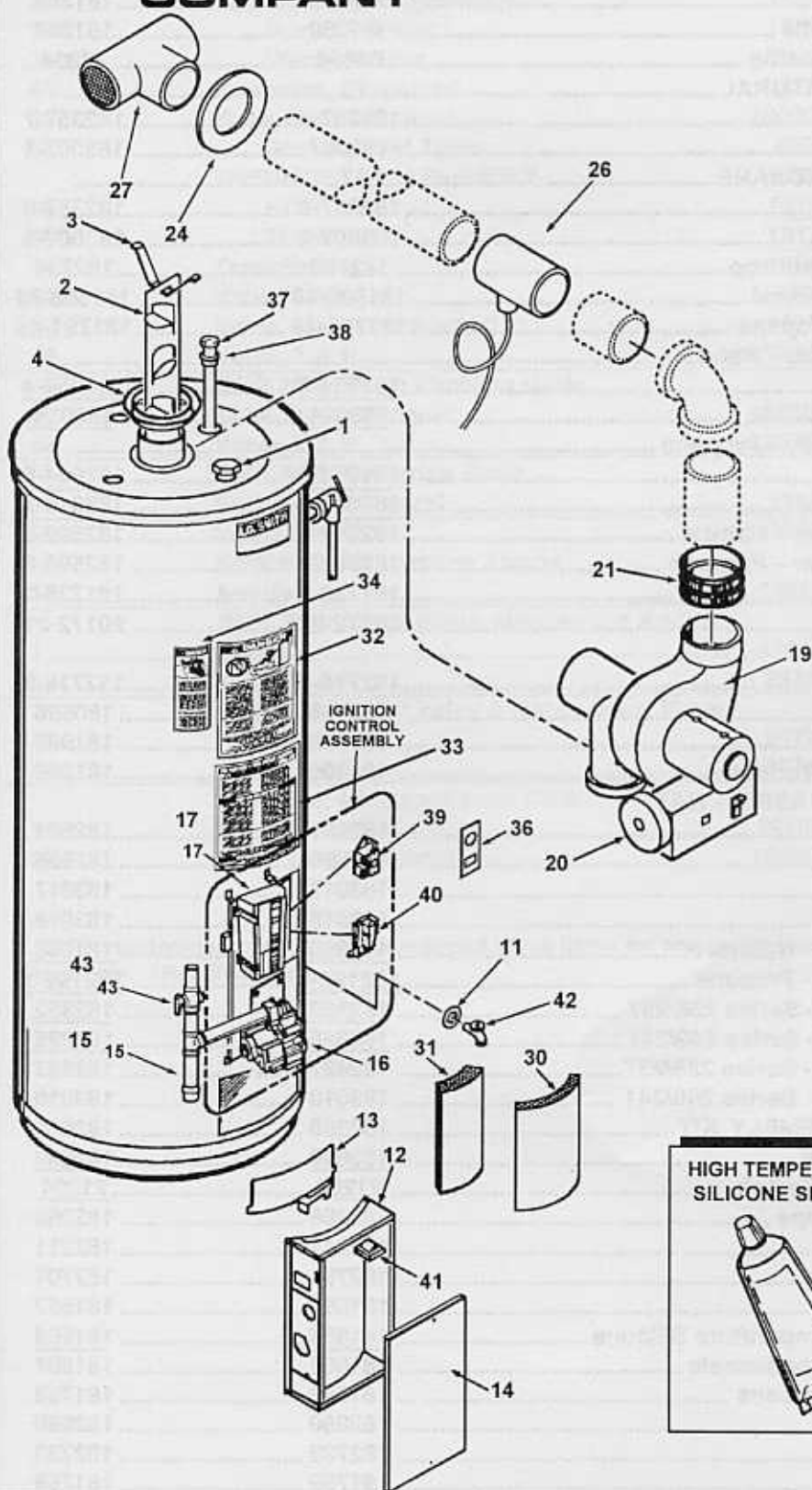

HARNESS WITH CLIPS
FOR BLOWER CONNECTION

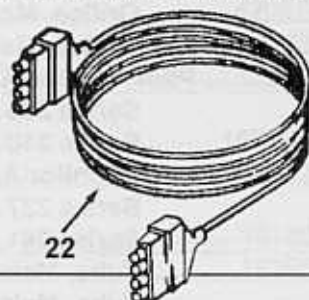

BURNER ASSEMBLY

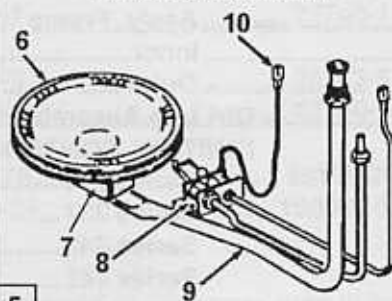

T & P RELIEF VALVE



HIGH TEMPERATURE
SILICONE SEALANT



A.O. SMITH WATER PRODUCTS CO., INC.

5621 W. 115TH STREET • ALSIP, ILLINOIS 60803

PHONE: 1-800-433-2545

FAX: 1-800-433-2515 • WWW.HOTWATER.COM

PRINTED IN U.S.A.

October 1998

Item	Description	FPSE-40	FPSE-50
		236/237/240/241	236/237/240/241
1	Anode, Outlet.....	43817-29	43817-29
	BAFFLE		
2	Baffle, Flue	181382	181382
3	Hanger, Flue Baffle	181360	181360
4	Restrictor, Flue Baffle	34894	34894
5	BURNER ASS'Y - NATURAL		
	Series 236	182357-6	182357-7
	Series 240	183007	183007-1
5	BURNER ASS'Y - PROPANE		
	Series 237	182357-8	182357-9
	Series 241	183007-2	183007-3
6	Burner, Main - Nat/Prop	182730	182730
7	Orifice, Main - Natural	181508-30	181508-30
7	Orifice, Main - Propane	181791-49	181791-49
8	Pilot / Ignitor Assembly - Natural		
	Series 236	181954-4	181954-4
	Series 240	183014	183014
8	Pilot / Ignitor Assembly - Propane		
	Series 237	181954-5	181954-5
	Series 241	183014-1	183014-1
9	Tube, Main Burner - Natural	182592-9	182592-8
9	Tube, Main Burner - Propane	182593-9	182593-8
10	Wire, Ground	181736-2	181736-2
11	Collar, Pipe	20172-21	20172-21
	DOOR		
12	Ass'y, Frame	182716-2	182716-2
13	Inner	180596	180596
14	Outer	181943	181943
15	Dirt Leg Assembly, Propane	181206	181206
	IGNITION CONTROL ASS'Y - NAT		
	Series 236	182891	182891
	Series 237	182886	182886
	Series 240	183017	183017
	Series 241	183018	183018
16	Gas Valve Ass'y - Natural	181950	181950
16	Gas Valve Ass'y - Propane	182192-1	182192-1
17	Module, Ignition - Series 236/237	182352	182352
17	Module, Ignition - Series 240/241	193325	193325
18	*Wiring Harness - Series 236/237	182887	182887
18	*Wiring Harness - Series 240/241	183010	183010
	INSTALLATION ASSEMBLY KIT	182650	182650
19	Blower Assembly	182649	182649
20	Air Pressure Switch	21204	21204
21	Coupling w/Clamps	182269	182269
22	Harness w/Clips	182211	182211
23	*Insert Sheet	182701	182701
24	Plate, Wall	181557	181557
25	Sealant, High Temperature Silicone	181564	181564
26	Tee Assembly, Condensate	181861	181861
27	Tee, Vent 3" w/Screens	181762	181762
28	*Insert Sheet	182890	182890
29	*Instruction Manual	182733	182733
30	Insulation, Barrier	181759	181759
31	Insulation, Thermostat Opening	43307-5	43307-5

Item	Description	FPSE-40 236/237/240/241	FPSE-50 236/237/240/241
Labels			
32	Flammable Vapor Warning	181139-1	181139-1
33	Lighting & Operating	182561	182561
34	Scald Warning	181138	181138
35	*Temperature	182734	182734
36	Protector, Personnel	182697	182697
37	Tube, Inlet w/Spacer	160907-34	160907-34
38	Spacer, Inlet Tube	42589	42589
THERMOSTAT ASSEMBLY		182648-1	182648-1
39	ECO	181706	181706
40	Thermostat	181705	181705
41	Transformer	192608	192608
42	Valve, Drain	42037	42037-1
43	Valve, Main Gas Shutoff	181737	181737
44	Valve, T & P	23740-1	23740-1
SMR H43; North Carolina Code			
37	Tube, Inlet w/Spacer	160501-34	160501-34
44	Valve, T & P	23740-1	23740-1
SMR S06; California Code			
29	Earthquake Manual	181809	181809
28	Insert Sheet	182552	182552
SMR S19; Magnesium Anode			
1	Anode	43816-29	43816-29
SMR S34; Relief Valve, Magnesium Anode			
1	Anode	43816-29	43816-29
44	Valve, T & P	23740-1	23740-1
SMR S35; Relief Valve & Brass Drain Valve			
42	Valve, Drain	26273-5	26273-5
44	Valve, T & P	23740-1	23740-1
SMR S44; Massachusetts Code			
1	Anode	29109-29	29109-29
37	Tube, Inlet w/Spacer	160501-34	160501-34

NOTE: Underlined parts are recommended stock items for emergency replacement. Consider gas used in your area only. *Not illustrated.