



**A.O. SMITH**  
WATER PRODUCTS  
COMPANY  
PSD - Alsip, Illinois

## **WATER HEATER BULLETIN**

Date: December 20, 1999  
Subject: Gas Water Heater Conversion Policy  
To: All Accounts

No. 137 Rev. 2

\* This supersedes all previous letters and field bulletins concerning residential and commercial water heater conversion.

### **GAS WATER HEATER CONVERSION POLICY**

All A.O. Smith Water Products Company's residential and commercial gas water heaters are designed certified by CSA or UL, under ANSI Standards for operation on one type of gas only, as indicated on the water heater's model number and rating plate.

A.O. Smith realizes that there may be certain situations where a field conversion may be necessary and in order to facilitate such a conversion, A. O. Smith complies with CSA or UL regulations ensuring that a field conversion be appropriately and safely completed.

An improper field conversion from one type of gas to another could cause potentially dangerous conditions that may cause an explosion or fire resulting in property damage, bodily injury or both.

**A.O. SMITH WILL ONLY ALLOW THE CONVERSION OF GAS WATER HEATERS FROM LP GAS (PROPANE) TO NATURAL GAS. THE CONVERSION OF A GAS WATER HEATER FROM NATURAL GAS TO LP GAS (PROPANE) IS NOT ALLOWED UNDER ANY CIRCUMSTANCES.**

A.O. Smith will provide kits as demand warrants through our Parts Department, phone no. 1-800-433-2545. Prices, dimensions and specifications are subject to change without notice.

Each conversion kit is to be installed by an A.O. Smith service agent or a gas utility serviceman in accordance with A.O. Smith's written instructions and all codes and requirements of the authority having jurisdiction. Failure to follow instructions could result in serious injury or property damage. The utility performing this work assumes responsibility for this conversion.

#### **Changing the Input on Gas Water Heaters**

The only changes to the input of a gas water heater allowed are:

- Adjustments to match that shown on the rating plate of the heater. The installation instructions supplied with the heater indicate if adjustments to input are a required procedure.
- Changes made as required to adjust the heater for proper operation at high altitude as determined by a qualified service technician. Service manuals include the proper procedure for adjusting heaters at high altitudes.

#### **Conversion of Gas Water Heaters**

The conversion of LP gas (Propane) to Natural gas is ONLY allowed providing:

- The conversion is done as part of a gas utility's program where propane appliances were installed anticipating the completion of natural gas service to the area. The conversion must be done under the direct supervision of the utility and by their service representatives.

Claims of damage or injury arising from the unauthorized conversion of any A.O. Smith water heater not design certified for conversion will be the complete and total responsibility of the person or entity making the conversion.

If you have any questions regarding the above policy, please contact the A.O. Smith Parts Department at 1-800-433-2545 or our Technical Information Center at 1-800-527-1953.

---

**A.O. SMITH WATER PRODUCTS CO., INC.**  
5621 W. 115TH STREET • ALSIP, ILLINOIS 60803  
PHONE: 1-800-433-2545  
FAX: 1-800-433-2515 • [www.hotwater.com](http://www.hotwater.com)

# GAS

PSD-3-402

## COMMERCIAL TANK TYPE WATER HEATER PARTS LIST

MODEL BTC-251 STANDARD AND ASME MODELS (A) SERIES 930

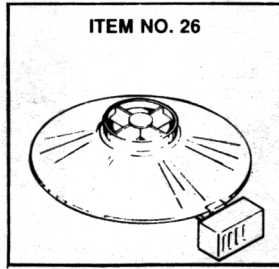

AUTOMATIC FLUE DAMPER DEVICE NOT AVAILABLE SEPARATELY - ENTIRE DRAFT HOOD ASSEMBLY MUST BE REPLACED

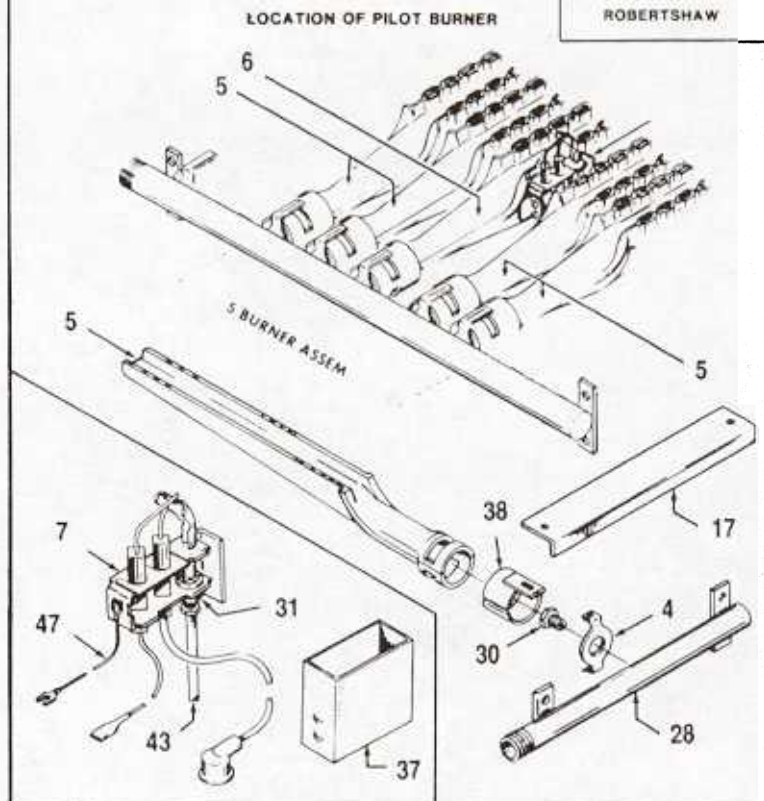
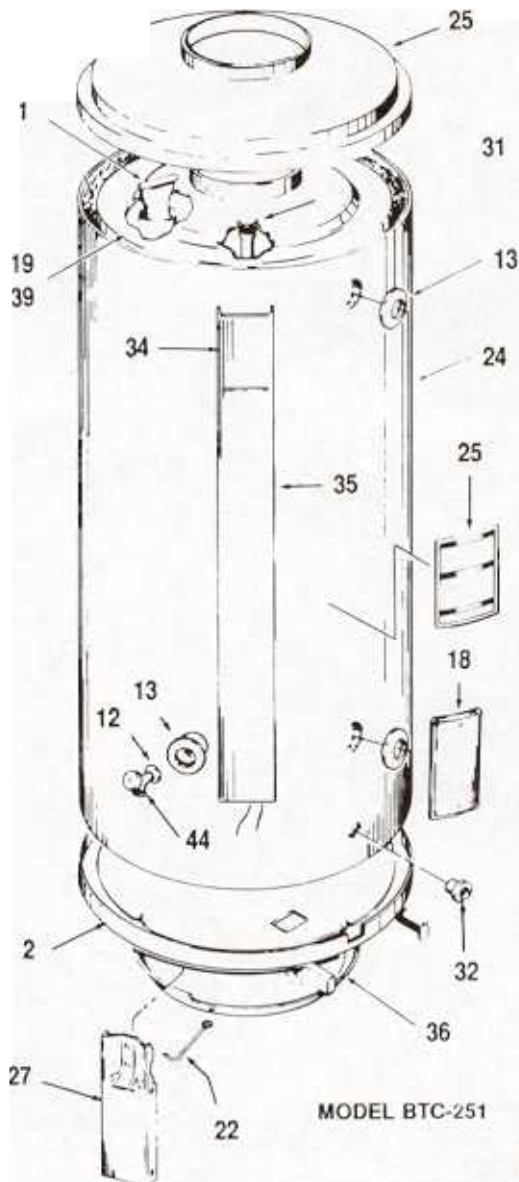
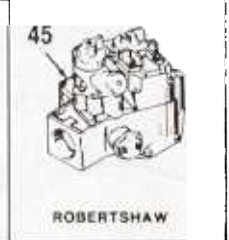
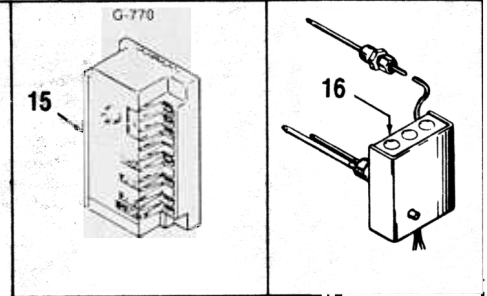
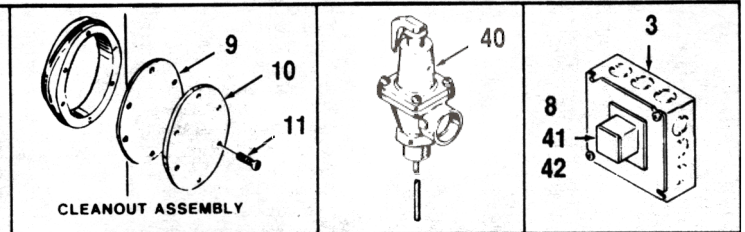

**A.O. SMITH**  
WATER PRODUCTS  
COMPANY

Item	Description	BTC-251
1	# Baffle, Flue	192199-1
2	Base, Jacket	98188-503
3	Box, Junction	93558
4	# Bracket, Main Burner Orifice	98044(5)
5	# Burner, Main	192281(4)
6	# Burner, Main - With Pilot Bracket	192297(1)
7	Burner, Pilot:	
	Natural Gas	<u>77944-12</u>
8	Cap, Terminal End	98206
9	Gasket	99038
10	Plate, Pressure	99037
11	Screws, Self-Tapping	69852
12	Collar, Pipe (Drain Valve)	20172-6
13	Collar (Inlet/Outlet)	95030-2
14	* Collar (Relief Valve)	95201
15	Control, I.I.D.:	
	Natural Gas	<u>190715</u>
16	Controller, Dual - With E.C.O.	<u>170336</u>
17	Cover, Burner	98185-2
18	# Cover, Cleanout	38445-700 (2)
19	Cover, Inner - Includes Item 54	78392
20	Cover, Jacket	97062-500
21	Hood, Draft - Low Profile Vertical	191792-007
22	# Hook, Hanger	98211(2)
	Insulation:	
23	*Top	41560-56
24	Jacket, Outer	192353
25	Label - Lighting and Operating	190841-3
26	* Labels:	
	Cleanout	78754
	C.E.C.	42985
	Combination:	
	Natural Gas	191940-0
	Damper	190743-18
	Help Line	190600
	Instruction	170345
	Lime Tamer	78640
	Pilot	77860
	Relief Valve	191068
	Water Inlet	94518
	Water Outlet	94519
	Wiring - Natural Gas	192374
27	# Leg	190992(3)
28	Manifold	76244-3
29	* Manual, Instruction	192351
30	# Orifice, Main Burner:	
	Natural Gas	76243-30(5)
31	Orifice, Pilot:	
	Natural Gas	6204
32	Port, Observation	98760
33	# Rod, Anode	43817-38(3)
	Shield, Door:	
34	Upper	170240
35	Lower	170240
36	Shield, Floor	98228-1
37	Shield, Pilot	170840
38	# Shutter, Air	170736(5)
39	Tape, Sealer	6158
40	Temperature & Pressure Relief Valve	191617
41	Terminal Segment	98205
42	Transformer	99238
43	Tubing, 1/4" x 60" w/assorted fittings	
	(cut to length)	1417-60
44	Valve, Drain	26273-6
45	Valve, Gas:	
	Natural Gas	192371
46	+* Wire: (See illustration for terminals.	
	Order as required.)	
	22 AWG Stranded, 250°C, Tan	78166
	18 AWG Stranded, 105°C, AWM & TEW	
	Black	78231
	Red	41976
	White	78230
	Yellow	78229
	16 AWG Stranded, 105°C, AWM & TEW	
	Black	86578
	White	86580
	14 AWG Stranded, 105°C, AWM & TEW	
	Green	41972
47	Wire, Ground	77948-6

\* Items not illustrated.

# Quantities shown in parenthesis next to part number.

+ When ordering wire, indicate length required in inches.  
(Example: 78231-100 equals 100" length).

Part numbers underlined are recommended stock items for emergency replacement. (Consider gas used in your area only.)

Request parts from Product Service Division by giving all information such as model and series number, type of gas and specifications.